

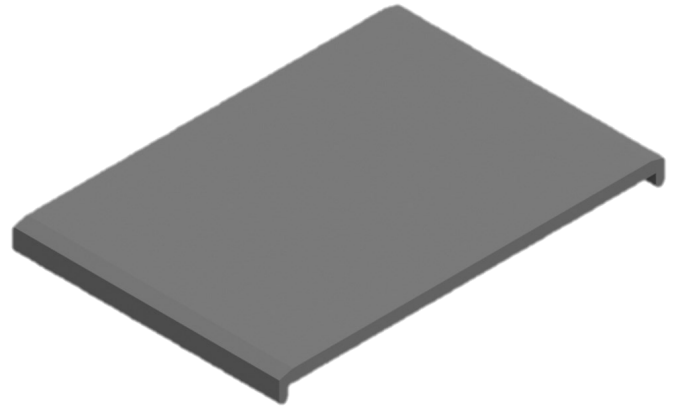

The **FD** pad has been specially designed for the soft mounting of crane rails, being mounted on a discontinuous surface of steel or concrete mix and steel.

The **FD** pads are manufactured from **wear resistant** and durable EVA copolymer. They are unaffected by oil, grease or ultraviolet light. The FD pads also incorporate tabs which lock on to the plate to **prevent pad displacement**.



Features:

- Help reduce the wear of the rail and its support.
- Absorb uneven surfaces.
- Improve the contact between rail and support.
- Suitable for all normal environmental conditions.
- Designed for service temperatures ranging from -25°C to 75°C
- Reduce noise and vibration.
- Pad Thickness - (7mm)

Mechanical Properties

Shore Hardness	95° A (ISO 868 A scale)
Tensile Strength	16N/mm ² (ISO R257)
Elongation	250% (ISO R257)
Temperature Range	-25°C to 75°C
Environment protection	Chemicals - Oil - Grease UV protection
For after ageing properties - Contact Technical Department	

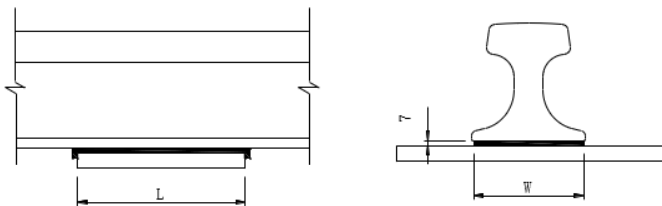

Installations Instructions

1. The FD pad is supplied narrower than the rail foot (W - 3-5mm Narrower).
2. The FD pad is placed on the soleplate.
3. The clips are placed on the soleplate.
4. The soleplate assembly is brought up to the base of the rail foot and clips fasten. The pad and soleplate are now levelled with the rail.
5. Rail levelling is performed.
6. Grout soleplate in place.

Please contact the technical department to be advised further in specific installation environments and conditions.

Pad Size - Pad Thickness (7mm)

Designation	Size (W)
FD - 110	Pad 111mm - Plate 110mm
FD - 120	Pad 121mm - Plate 120mm
FD - 165	Pad 166mm - Plate 165mm
FD - 205	Pad 206mm - Plate 205mm
FD - 220	Pad 221mm - Plate 220mm
FD - 250	Pad 251mm - Plate 250mm
FD - 320	Pad 321mm - Plate 320mm